



AMERICAN FLOOR PRODUCTS COMPANY, INC.

AFCO-USA

P.O. BOX 7055 • Gaithersburg, Maryland 20898 -7055 • 301-987-0490 • Fax 301-987-0422

email: sales@afco-usa.com • Web Site: www.afco-usa.com

Installation Instructions: CHINOOK[®] (WG-2114)

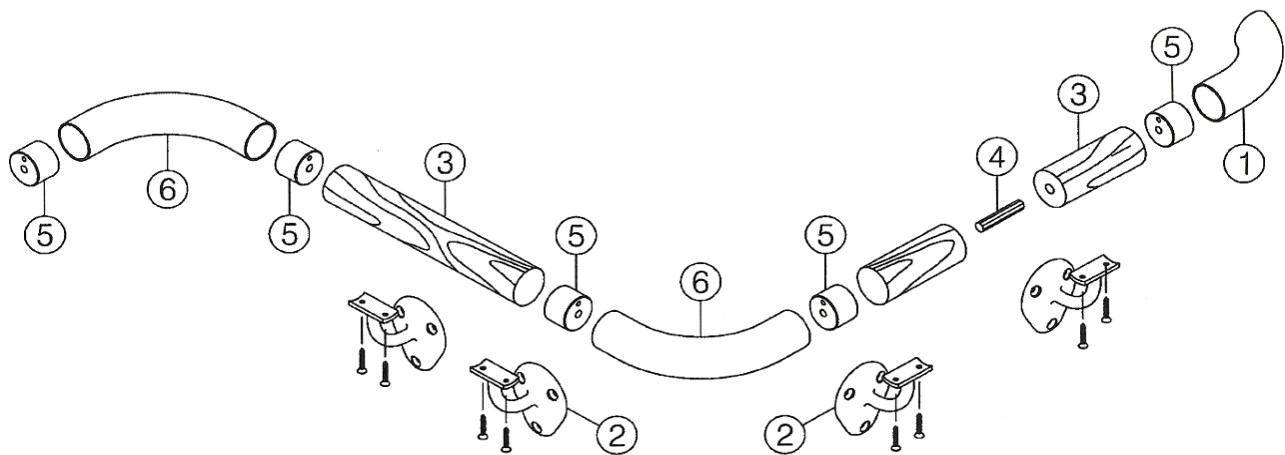
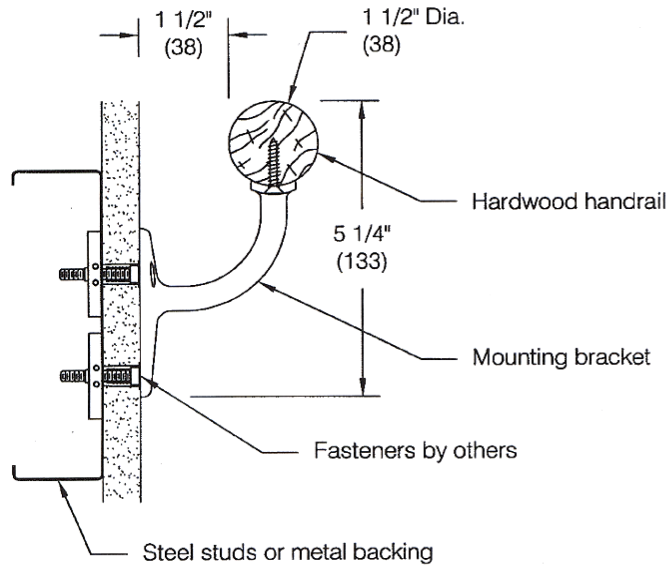

Component Part Numbers:

- (1) Left/Right Return
- (2) Bracket
- (3) Wood Rail
- (4) Splice
- (5) Insert
- (6) Inside/Outside Corner



AMERICAN FLOOR PRODUCTS COMPANY, INC.

AFCO-USA

P.O. BOX 7055 • Gaithersburg, Maryland 20898 -7055 • 301-987-0490 • Fax 301-987-0422
email: sales@afco-usa.com • Web Site: www.afco-usa.com

Installation Instructions: CHINOOK[®] (WG-2114)

Step 1: Determine top of handrail height and snap a chalk line 3 1/16" below for the centerline of the mounting hardware associated with the two upper mounting holes, see **fig. 1**.

Important: Store material in a clean dry place where the temperature is maintained above 50°F (10°C). Walls and rooms should be maintained at a minimum of 65°F (18°C) for at least 48 hours prior to installation. Acclimate materials to normal building conditions for at least 24 hours before cutting and installing.

Step 2: Locate and drill bracket mounting holes in wall construction. Mark the location of all three holes while aligning the center of the two uppermost holes with the chalk line provided in **step 1**. Choice of hardware will dictate hole diameter.

Brackets must be spaced:

- Not to exceed 32" on center
- 1-7/8" to 6" on center from end of wood rail at returns and corner accessories
- A maximum of 3" from end of wood at splice to provide support at splice, see **fig. 7**
- To align with metal studs (on metal stud construction) or preferably with horizontal metal backer plate (by others)

Step 3: Mount brackets to wall with the appropriate hardware according to wall construction.

Suggested hardware:

- Drywall: Toggler[®] brand toggle bolts
- Masonry: Plastic Alligator[®] insert

Step 4: Layout and cut wood rail. See **Cutting Adjustment Diagrams and Schedule** for adjustments to wood rail length at wall returns and comers. Refer to **Minimum Layout Configurations** for additional information. Care should be taken to select the straightest lengths of wood for the longest handrail spans. See **step 9** for splicing information.

Important: All cuts must be square. Deburr using 120 grit sandpaper being careful not to damage finish.

Step 5: Color the perimeter of unfinished wood rail ends using a stain pen or touch-up stain, see **fig. 2**.

Step 6: With wood rail cut to length use BRJ-1600 drill jig to locate and drill mounting hole for BRA-1625 aluminum insert at all locations that will receive a wall return or corner accessory, see **fig. 3**. With drill jig seated flush against end of rail drill into wood a minimum of 1" deep using a 3/16" diameter drill bit in the jig center hole.

Important: Drill jig is double ended, always use best fitting end

Step 7: Install BRA-1625 aluminum insert using #14 x 2" hex washer head screw provided. Keep aluminum insert centered on wood rail while tightening. With aluminum insert in place, drill into wood approximately 3/4" using a #27 bit using the small hole provided in the insert as a guide. To prevent the insert from rotating, install #8 x 1-1/2" Philips round head wood screw (provided), see **fig. 4**.

Step 8: Locate wood rail on wall bracket saddles and pre-drill for #8x1" Philips oval head wood screws (provided) using a #18 bit.

Important: Be sure to install corner accessories between rails before securing rail at both sides of corner. Use adhesive to install corner accessories as noted in **step 9** for handrail returns, see **fig. 5**.

Step 9: Refer to **fig. 7** for splicing of wood rail. Locate splice a maximum of 3" from bracket (see step 2). Using BRJ-1600 installation jig, drill 3/16" diameter pilot hole 1" deep in opposing ends of wood rail. Using a 3/8" diameter drill increase pilot hole for 3/8" diameter dowel pin. Apply a small amount of adhesive in each hole, insert dowel pin, and butt rails tightly together.

Important: Drill jig is double ended, always use best fitting end.

Step 10: Install BR-1625 wall returns by applying a 1/8" bead of ADH-50 adhesive (provided) inside the accessory opening, see **fig. 5**. With adhesive in place slide return or corner accessory over BRA-1625 insert and align with wall construction, see **fig. 6**.

Important: It will be necessary to hold wall return and corner accessories in place while adhesive cures to prevent movement or an undesirable gap from forming at the wood rail joint. Apply tape over butt joint seam to hold accessory in place, when the adhesive dries remove tape being careful not to damage the finish.



AMERICAN FLOOR PRODUCTS COMPANY, INC.

AFCO-USA

P.O. BOX 7055 • Gaithersburg, Maryland 20898 -7055 • 301-987-0490 • Fax 301-987-0422
email: sales@afco-usa.com • Web Site: www.afco-usa.com

Installation Instructions: CHINOOK[®] (WG-2114)

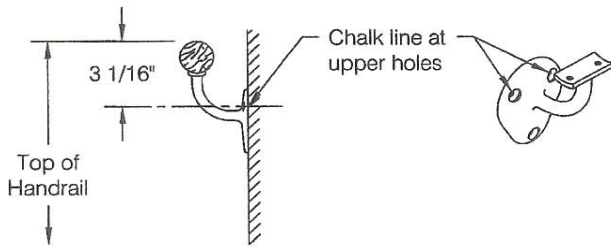

fig 1

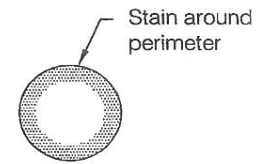

fig 2



fig 3

#8 x 1-1/2" wood screw

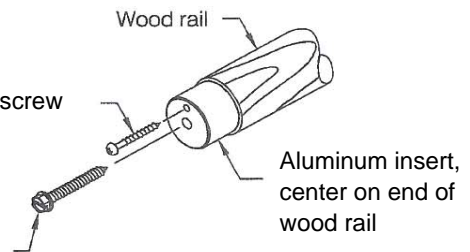

fig 4

#14 x 2" Hex washer head

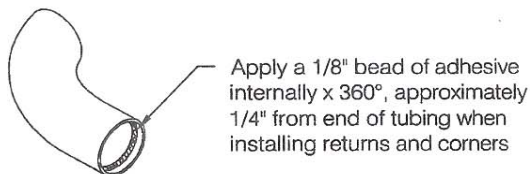

fig 5

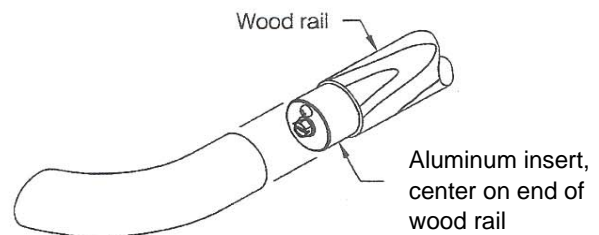

fig 6

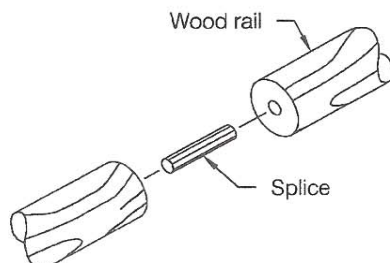

fig 7



AMERICAN FLOOR PRODUCTS COMPANY, INC.

AFCO-USA

P.O. BOX 7055 • Gaithersburg, Maryland 20898 -7055 • 301-987-0490 • Fax 301-987-0422

email: sales@afco-usa.com • Web Site: www.afco-usa.com

Installation Instructions: CHINOOK[®] (WG-2114)

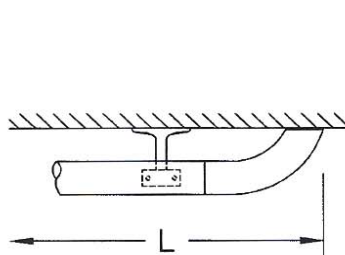

Return

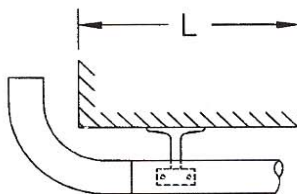

Outside Corner

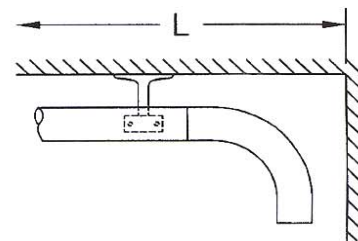

Inside Corner

Wood Rail

Return	L - 5 1/16"
Outside Corner	L - 2 1/4"
Inside Corner	L - 6 3/4"

Minimum Layout Configurations

